



Status Indicators and Connections

Screw-down I/O

Insert I/O Modules
Screw-down two captive screws into the two threaded retainers on the base.

Remove I/O Modules
Remove by unscrewing the two captive screws on the sides of the module.

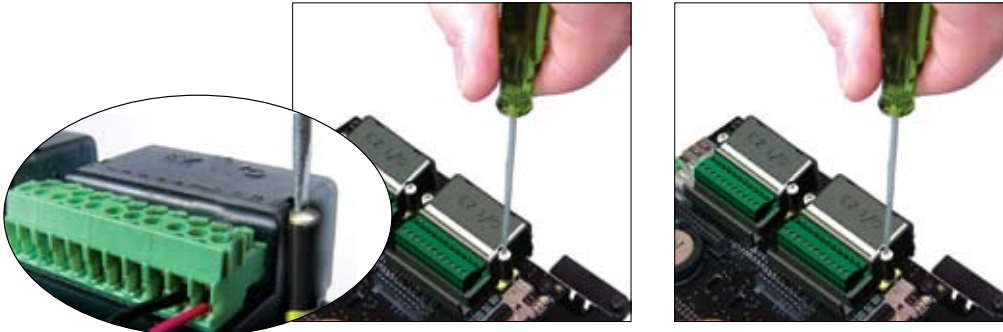

Caution: Do not use AC output module in the bottom left slot due to height of the battery. Analog IN/OUT module can be used only on the first 4 slots. Other analog modules or High Speed counter module can be used only in the first ten slots. **Avoid excessive force while screwing down to avoid stripping.**

Optional Ethernet connectivity

RS422/485 ASCII Port

Used to send ASCII instructions to other devices

SD-
SD+
RD+
RD-



RS232 Programming Port

Used to program PLC or TextPanel

Pin #	Function
2	TXD
3	RXD
5	Logic GND
Rest	NC

110 VAC or 24 VDC Power Input

Snap-in I/O

Remove I/O Modules

Removed from the slots by pressing the two clips on the side of the module.

Insert I/O Modules

Snapped into the two slots



DeviceNet, Profibus Optional Port

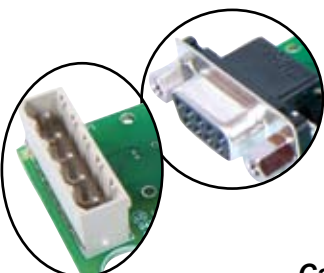

Power LED
CPU LED
Low Battery LED



Back side of EZ I/O module

Caution: Do not use AC output module in the bottom left slot due to height of the battery. Analog IN/OUT module can be used only on the first 4 slots. Other analog modules or High Speed counter module can be used only in the first ten slots.

EZ Remote I/O